

## LED Eco High Bay Light 100W Low Bay - Warehouse Industrial UFO Fitting - 250W SON Replacement Flicker Free

~~\$57.98~~ **\$50.35**

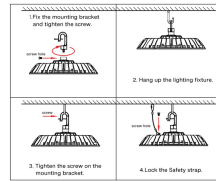

### INSTALLATION INSTRUCTIONS



### LED UFO High Bay DIMENSIONS

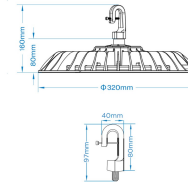

### LED UFO High Bay DIMENSIONS

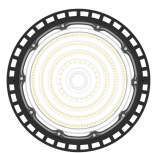
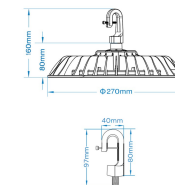

### PRODUCT INFORMATION

LED Type	Philips Lumileds LUXEON® SMD 2835 Leds
Warranty	3 Year
Part L Compliant	Yes
Dimensions	Ø270mm x 160mm
Weight	3.5kg
Equivalent to	250W SON

### TECHNICAL SPECIFICATIONS

Power Consumption	100W
Input Voltage	100-280V AC
Power Factor	>0.95
Operating Temperature	-20°C to 50°C
L70 Rated Lifetime	+100,000hrs
Ingress Protection	IP65

### LUMEN PERFORMANCE

Luminous Efficiency	130lm/W
Beam Angle	90°
CRI (Colour Rendering Index)	>80Ra
Lumen Output	13,000lm

### AVAILABLE OPTIONS

Colour Temperature	Natural White 4000K
3-Hour Emergency Version	No
Built-in Microwave Occupancy Detector	No
1-10V Dimmable	Available on Request

LED Eco High Bay Light 100W Low Bay - Warehouse Industrial UFO Fitting are designed specifically for installations requiring high level light mounting from 6 - 12m. With industrial applications in mind, these units replace up to 400W metal halide type

fittings: with the added benefit of 75% energy savings, improved lumen performance & improved CR (Colour Rendering Index: ideal in packing warehouses), as well as long life meaning annual re-lamp & expensive lift equipment/inconvenience is negligible.

The UFO Series is available in 3 options: 100W/150W/200W, comprised of high performance Lumileds LUXEON® SMD 2835 LEDs. Manufactured from die-cast aluminium with a matt black finish, the housing provides strong protection, durability and heat dissipation for the LEDs. The toughened glass diffuser greatly reduces glare and the Nano-material reflector further enhances efficacy up to 125lm/W in a standard colour temperature of 4000K (others on request).

Further options include dimmable options: 1-10V

Durable with a rated life span of +100,000 hours / No UV or IR emissions / Instant on & Flicker free / CE & RoHS international standards / Environmentally friendly & part recyclable: no mercury or other hazardous materials used / One-piece Die cast aluminium heat sink / Toughened Glass optic lens / Mounting options of Mounting Hook or Surface Mount Bracket.

[DOWNLOAD PRODUCT INSTALLATION MANUAL / GUIDE](#)