

90-305VAC
IP66
IK10

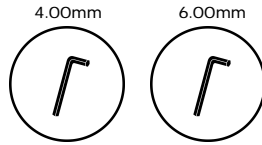
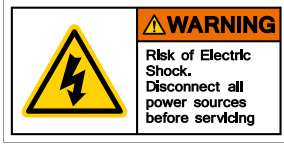

WARNING - THIS LUMINAIRE MUST BE EARTHED

This luminaire has been tested and is manufactured to comply with BS EN 60598: specification for general requirements and tests. It should be installed by a suitably qualified person in accordance with IEE.

CAUTION: there is a potential risk of electric shock from the LED boards when the product is operational with the cover removed.

NOTE: INSTALLATION AND OPERATION OF THE LUMINAIRE BEYOND ITS SCOPE OF SUPPLY WILL INVALIDATE THE WARRANTY.

SED-0618-0001

1.

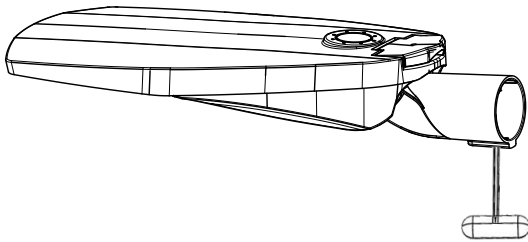

Using a 4mm Allen Key, loosen all the grub screws sufficiently to allow for the column bracket diameter.

2.

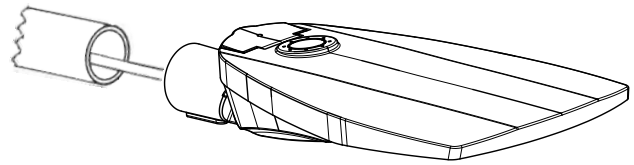

Feed the mains cable into the column and offer the spigot up to the column bracket (up to 60mm diameter).

3.

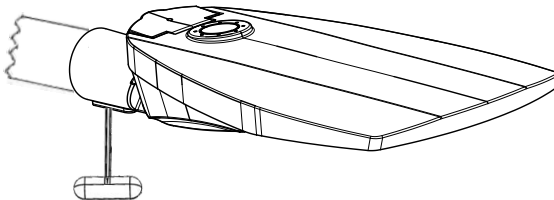

Using a 4mm Allen Key, tighten all the grub screws slightly so the fitting can still rotate.

4.

Spirit level to ensure the fitting is level

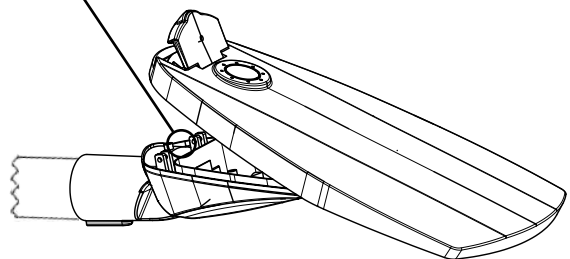

Open the release handle and lift the lid to expose the internal spirit level.

5.

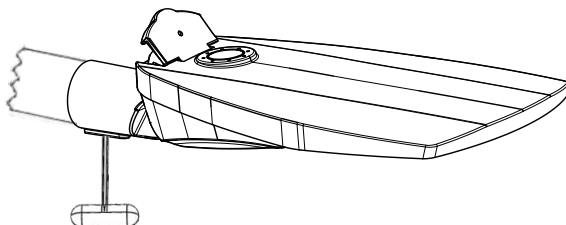

Once the fitting is level, fully tighten the grub screw to a maximum **11Nm - STRICTLY DO NOT OVERTIGHTEN.**

6.

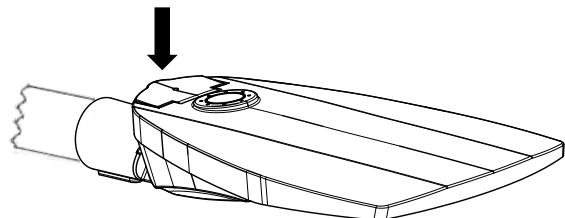

To close the lid, apply force to the centre of the release handle and always check that the lid has been closed properly. The release handle should sit flush with the housing when closed.

SED-0618-0001

7. Optional

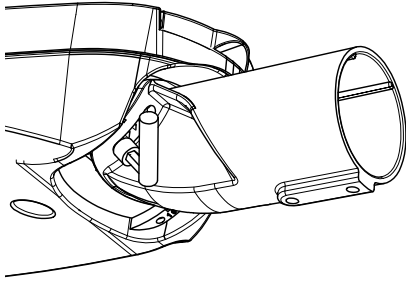

To adjust the vertical mounting angle, loosen the M8 bolts on the spigot using a 6mm hex key. **DO NOT FULLY REMOVE.**

8.

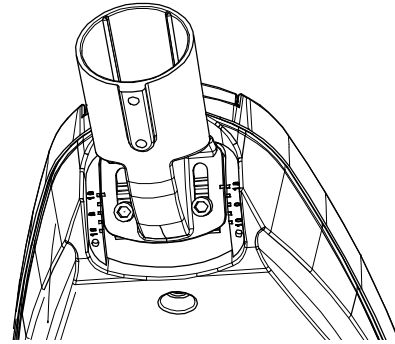

Raise or lower the InfinityII Column Head as needed. The spigot can be adjusted in 5° increments from -10° to +10°.

9.

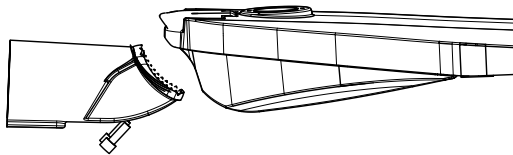

To change the spigot mount to a Post-Top orientation, remove the two M8 bolts from the rear, rotate the spigot 90°.

10.

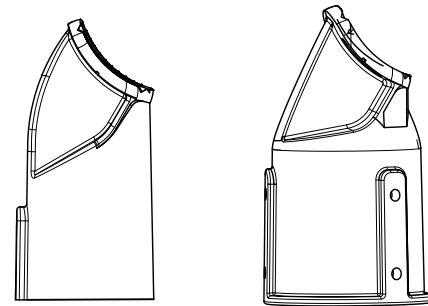

SDINF2-BR-60
60mm Spigot

SDINF2-BR-76
76mm Spigot

Confirm spigot size before installation.

11.

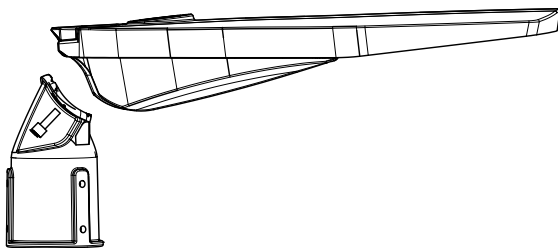

Re-attach the bolts, raise or lower the InfinityII Column Head as needed. The spigot can be adjusted from -10° to +10°, each marking represents a 5° increment. Fully tighten the bolts to **11Nm MAX.**

12.

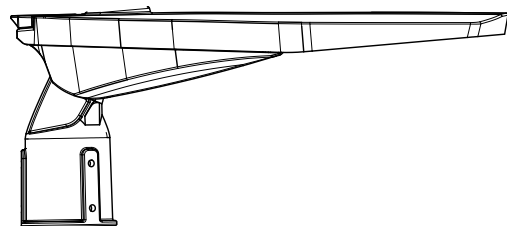

Follow steps 1-8 to install on a Column.

Luminaire must be operated within an ambient fixture temperature of -20°C to 50°C to comply with all safety and warranty regulations. Ensure sufficient air flow around the luminaire for efficient heat dissipation. Failure to do so could significantly reduce luminaire life and/or safety/warranty regulations.

NOTE: Installation of LED luminaire with modification to the unit, or incorrect fitting in accordance with the above instructions could result in damage/failure of the luminaire, which may invalidate warranty.

MANUFACTURER'S GUARANTEE

This product is guaranteed in the country of purchase for the number of years as stated from the date of purchase. The guarantee is invalid in the case of improper use, installation, tampering, removal of the Q.C. date label, installation in an improper working environment or installation not in accordance with the advised instructions and/or national wiring regulations. Should this product fail during the guarantee period it will be replaced free of charge, subject to correct installation and return of the faulty unit. We do not accept responsibility for any installation costs associated with the replacement of this product. This warranty is in addition to the statutory rights in your country of purchase and reserve the right to alter specifications without prior notice.